

# ApexPilot® All-In-One

## Cordless Endodontic Handpiece Built-in Apex Locator

The most convenient root canal treatment system, complete root canal length measurement and root canal preparation on the handpiece, you just need to connect a lip hook with the motor to make the canal length measurement and preparation at the same time.



### Convenient Working Modes

It can be used with built-in apex Locator, or optional bluetooth function, displayed data synchronize with ApexPilot locator, perfect visibility.

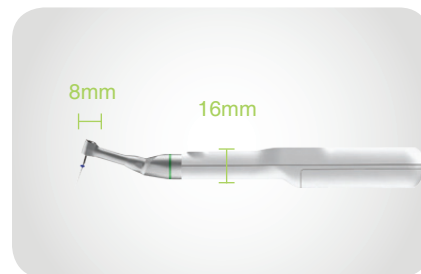

### Portable, Smart & Cordless

Cordless endodontic handpiece design. Safe and reliable medical equipment to let doctors use more handy.

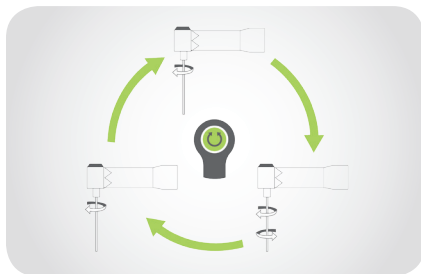

### Quick Start

Only one button can achieve root canal length measurement and preparation. The doctor can set the most commonly used parameters to this function, such as speed, torque, rotation mode.

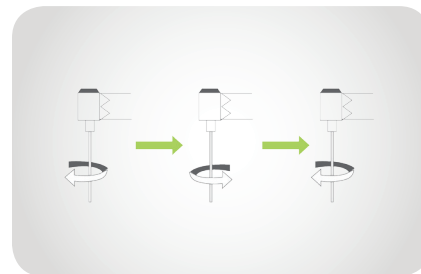

### Auto Reverse

When it continues applying a load and it exceeds the torque limit value, it will automatically turn to AUTO REVERSE mode, the file will rotate reversely.

## Technical Data

<b>Material:</b>	280 x 25 x 26mm (central unit include contra angle), 123 x 61 x 81mm (battery charger)
<b>Weight:</b>	780g
<b>Type:</b>	Portable
<b>Memory:</b>	5 memory setting + quick start memory
<b>Rotation:</b>	Clockwise / Anti-clockwise / Recipracating
<b>Charging:</b>	Charging base / USB
<b>Dispaly:</b>	LED / Bluetooth
<b>Available Contra Angle:</b>	10:1 16:1 20:1
<b>Apex Locator Control Motor Working Mode:</b>	Auto Start / Auto Stop / Auto Reverse

## Order Information



Code: **AL2020**  
Model: **ApexPilot All-In-One**

Part and its accessories:

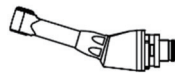

Code: **ALP101**  
Model: **16:1 contra angle**

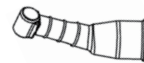

Code: **ALP119**  
Model: **Silicone Sleeve**

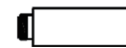

Code: **ALP111**  
Model: **Spray nozzle**



Code: **ALP107**  
Model: **Adaptor**



Code: **ALP104**  
Model: **Battery**



Code: **ALP003**  
Model: **Lip hook**



Code: **ALP121**  
Model: **Charging base**



Code: **ALP108**  
Model: **Charging wire**



Code: **ALP110**  
Model: **Measuring line**

**Beyes**<sup>®</sup>

The Next Standard<sup>®</sup>

**Beyes Dental Canada Inc.**  
30 Casebridge Court  
Toronto, Ontario, M1B 3M5  
Canada  
Tel: 1-416-281-1888  
Email: info@beyes.ca  
Website: www.beyes.ca

Your Dealer for Beyes Products



Printed in Canada.  
ENB001R1

© Beyes Canada Inc 2017. All Rights Reserved.  
Specifications are subject to change without notice.  
All brands are holders of their respective trademarks.